



Planning Act 2008
Infrastructure Planning
(Applications Prescribed
Forms and Procedure)
Regulations 2009

North Lincolnshire Green Energy Park

Volume 4

APFP Regulation 5(2)(o)

4.14 Indicative Highways drawings

PINS reference: EN010116

January 2023

Revision number: 1



The North Lincolnshire Green Energy Park Development Consent Order

4.14 Indicative Highways Drawings

Date: January 2023

PINS reference: EN010116

Application Document Reference: 4.14

Author: Buro Happold

CONTENTS

CONTENTS	1
1. INTRODUCTION	2
1.1 General	2
2. SCHEDULE OF PLANS INCLUDED IN THIS APPLICATION DOCUMENT	3
NLGEP-BHE-XX-XX-DR-C-2270	3
NLGEP-BHE-XX-XX-DR-C-2274	3
NLGEP-BHE-XX-XX-DR-C-2275	3

1. INTRODUCTION

1.1 General

1.1.1 The following Plans have been prepared to accompany the application for a Development Consent Order (DCO), made by the Applicant to the Secretary of State (SoS) via the Planning Inspectorate (the Inspectorate).

1.1.2 A detailed description of the Project can be found in Chapter 3 of the ES (**Document Reference 6.2.3**).

1.1.3 These Plans comprise part of the suite of Application documentation and are included in the Application in compliance with Regulation 5(2)(o) of the Infrastructure Planning (Applications: Prescribed Forms and Procedure) Regulations 2009 (the 2009 Regulations), which requires:

(o) any other plans, drawings and sections necessary to describe the proposals for which development consent is sought, showing details of design, external appearance, and the preferred layout of buildings or structures, drainage, surface water management, means of vehicular and pedestrian access, any car parking to be provided, and means of landscaping;

1.1.4 These Plans are also being submitted under Regulation 5(4) of the 2009 Regulations which states:

"Where a plan comprises three or more separate sheets a key plan must be provided showing the relationship between the different sheets."

1.1.5 To assist the interpretation of these Plans, a key plan shows ten separate sheets which cover the Order Limits. Where there are no works shown on a separate sheet, "Sheet X Not Used" is shown on the key plan. Only the sheets showing relevant information are provided.

1.1.6 These Plans are part of the Application documentation and should be read alongside and are informed by the other Application documents.

2. SCHEDULE OF PLANS INCLUDED IN THIS APPLICATION DOCUMENT

Drawing Number	Drawing Title	Revision
NLGEP-BHE-XX-XX-DR-C-2270	INDICATIVE HIGHWAYS PLAN OVERALL SHEET	P1
NLGEP-BHE-XX-XX-DR-C-2274	INDICATIVE HIGHWAYS PLAN SHEET 4	P0
NLGEP-BHE-XX-XX-DR-C-2275	INDICATIVE HIGHWAYS PLAN SHEET 5	P1

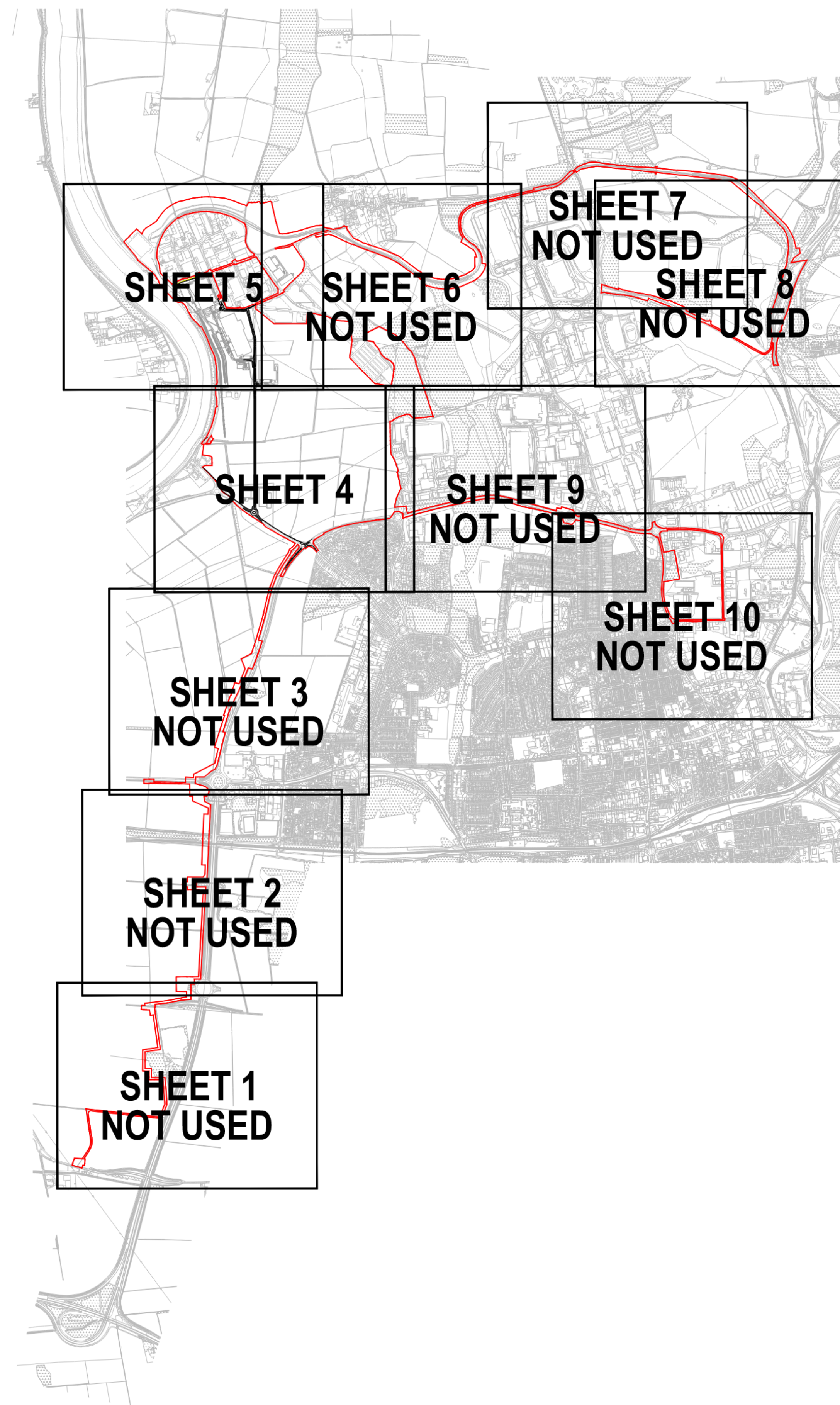
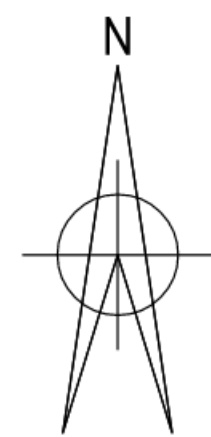

NOTES:

- THIS DRAWING SHOULD BE READ IN CONJUNCTION WITH ALL OTHER RELEVANT DRAWINGS AND SPECIFICATIONS.
- DRAWINGS BASED ON THE FOLLOWING BACKGROUND INFORMATION:
 - ORDNANCE SURVEY MAPS RECEIVED © CROWN COPYRIGHT AND DATABASE RIGHTS 2021 OS LICENCE 100035409
- THE COMPLETENESS OF THE UNDERGROUND SERVICE INFORMATION CANNOT BE GUARANTEED AND THEREFORE OTHER SERVICES MAY EXIST.

LEGEND

PROPOSED

- SITE BOUNDARY
- PROPOSED HIGHWAY LAYOUT
- PROPOSED WAITING TIME RESTRICTION

2.80

PROPOSED INDICATIVE LEVELS (mAOD) THAT CAN DEVIATE UP TO 1m HIGHER OR LOWER (BUT NO LESS THAN THE MINIMUM FRA RECOMMENDED LEVELS)

P1	UPDATED RED LINE BOUNDARY	09.01.2023	FR	CB	CB
P0	ISSUED FOR DCO SUBMISSION	09.05.2022	FR	CB	CB
Rev	Description	Date	Iss'd	Rev'd	App'd

DCO SUBMISSION

Project Stage

INFORMATION

Status of Drawing

Client

Level 33, Euston Tower, 296 Euston Rd., London, NW1 3DP

LD&DESIGN GSDA FICHTNER
ERM CONSULTING ENGINEERS LTD

BURO HAPPOLD northern planners bowland ecology

Client **NORTH LINCOLNSHIRE GREEN ENERGY PARK LTD**

Consultant **BURO HAPPOLD**

Project **NORTH LINCOLNSHIRE GREEN ENERGY PARK**

Dwg Title **INDICATIVE HIGHWAYS PLAN OVERALL SHEET**

Planning Inspectorate No. EN010116	Scale@A1 1:20000	
Drawn/Designed By J.SLEEMAN	Checked By C.BYRNE	Approved By C.BYRNE
Drawing No. NLGEP-BHE-XX-XX-DR-C-2270	Revision P1	

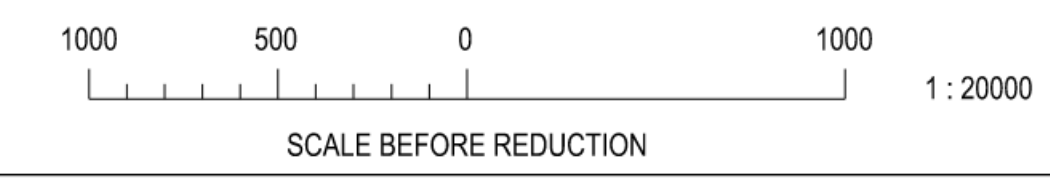

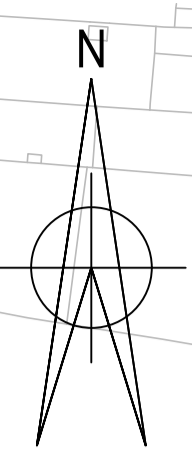
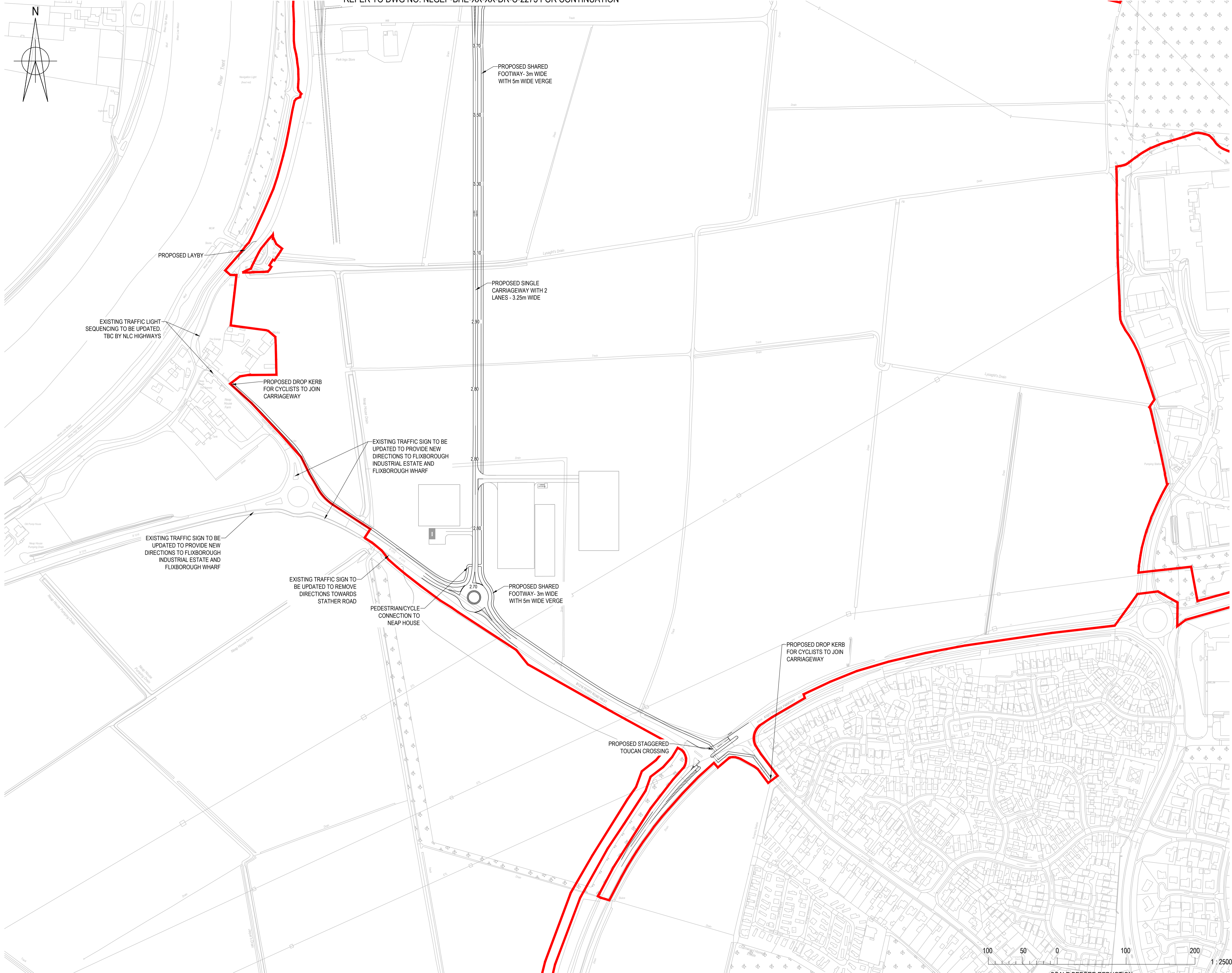

Planning Act 2008
The Infrastructure Planning (Applications: Prescribed forms and Procedure) Regulations 2009
Regulation 5(2)(e)

- NOTES:**
- THIS DRAWING SHOULD BE READ IN CONJUNCTION WITH ALL OTHER RELEVANT DRAWINGS AND SPECIFICATIONS.
 - DRAWINGS BASED ON THE FOLLOWING BACKGROUND INFORMATION:
 - ORDNANCE SURVEY MAPS RECEIVED © CROWN COPYRIGHT AND DATABASE RIGHTS 2021 OS LICENCE 100035409
 - THE COMPLETENESS OF THE UNDERGROUND SERVICE INFORMATION CANNOT BE GUARANTEED AND THEREFORE OTHER SERVICES MAY EXIST.

LEGEND

PROPOSED	
	SITE BOUNDARY
	PROPOSED HIGHWAY LAYOUT
	PROPOSED WAITING TIME RESTRICTION
2.80	PROPOSED INDICATIVE LEVELS (mAOD) THAT CAN DEVIATE UP TO 1m HIGHER OR LOWER (BUT NO LESS THAN THE MINIMUM FRA RECOMMENDED LEVELS)

P0	ISSUED FOR DCO SUBMISSION	09.05.2022	FR	CB	CB
Rev	Description	Date	Iss'd	Rev'd	App'd

DCO SUBMISSION

Project Stage

INFORMATION

Status of Drawing

Client

Level 33, Euston Tower, 296 Euston Road, London, NW1 3DP

Client: NORTH LINCOLNSHIRE GREEN ENERGY PARK LTD
 Consultant: BURO HAPPOLD
 Project: NORTH LINCOLNSHIRE GREEN ENERGY PARK
 Dwg Title: INDICATIVE HIGHWAYS PLAN SHEET 4

Planning Inspectorate No. EN010116	Scale@A1 1:2500	
Drawn/Designed By J.SLEEMAN	Checked By C.BYRNE	Approved By C.BYRNE
Drawing No. NLGEP-BHE-XX-XX-DR-C-2274	Revision P0	



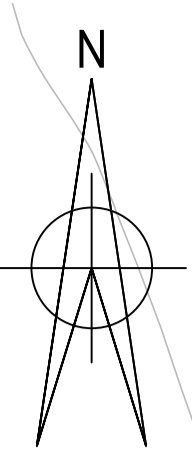

- NOTES:**
- THIS DRAWING SHOULD BE READ IN CONJUNCTION WITH ALL OTHER RELEVANT DRAWINGS AND SPECIFICATIONS.
 - DRAWINGS BASED ON THE FOLLOWING BACKGROUND INFORMATION:
 - ORDNANCE SURVEY MAPS RECEIVED © CROWN COPYRIGHT AND DATABASE RIGHTS 2021 OS LICENCE 100035409
 - THE COMPLETENESS OF THE UNDERGROUND SERVICE INFORMATION CANNOT BE GUARANTEED AND THEREFORE OTHER SERVICES MAY EXIST.

LEGEND

PROPOSED	
	SITE BOUNDARY
	PROPOSED HIGHWAY LAYOUT
	PROPOSED WAITING TIME RESTRICTION
2.80	PROPOSED INDICATIVE LEVELS (mAOD) THAT CAN DEVIATE UP TO 1m HIGHER OR LOWER (BUT NO LESS THAN THE MINIMUM FRA RECOMMENDED LEVELS)

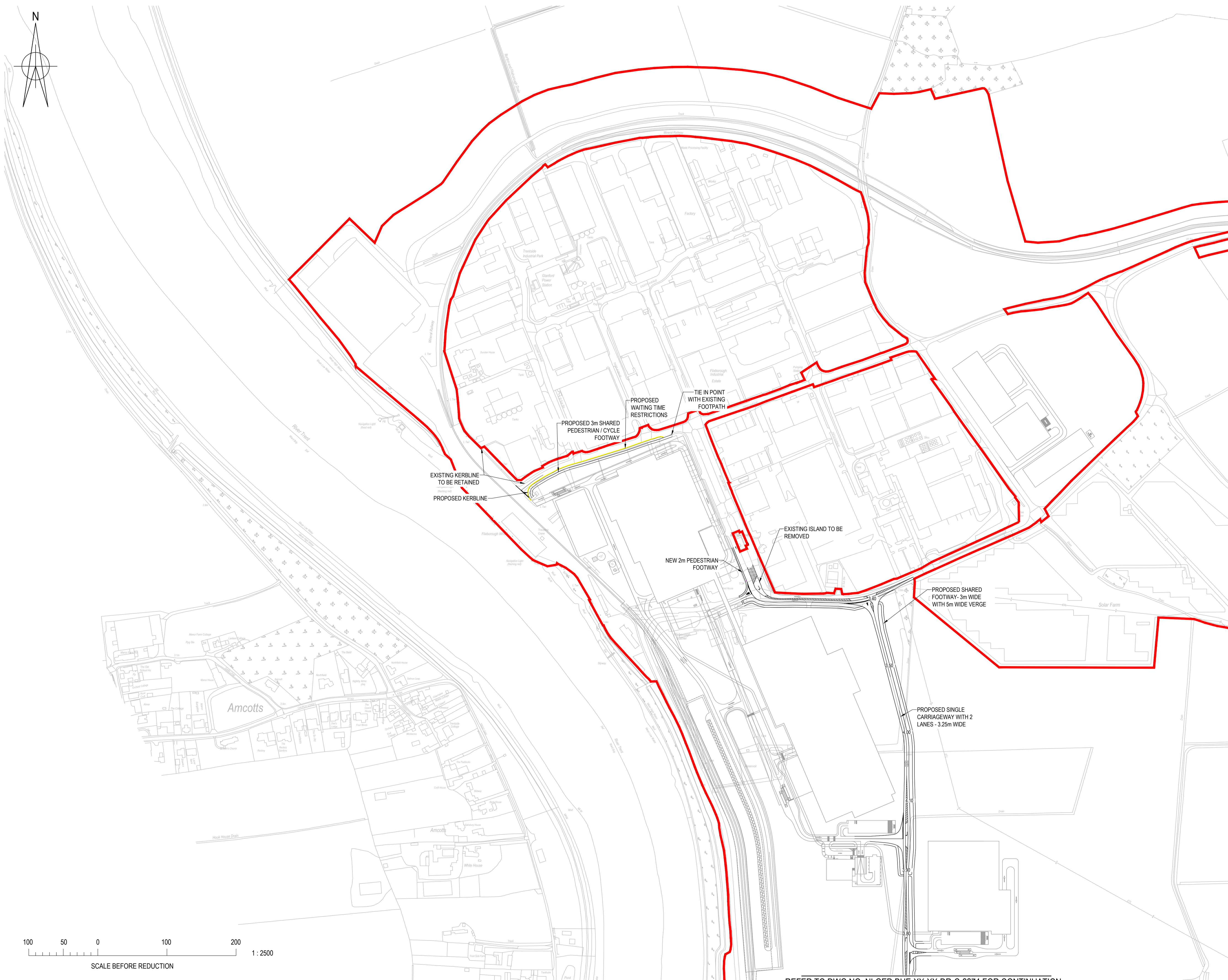

P1	UPDATED RED LINE BOUNDARY	09.01.2023	FR	CB	CB
P0	ISSUED FOR DCO SUBMISSION	09.05.2022	FR	CB	CB
Rev	Description	Date	Iss'd	Rev'd	App'd

DCO SUBMISSION

Project Stage

INFORMATION

Status of Drawing

Client

Level 33, Euston Tower, 296 Euston Road, London, NW1 3DP

LD A DESIGN GSDA FICHTNER
ERM COLLECTIVE INFRASTRUCTURE

BURO HAPPOLD northern planners bowland ecology

Client: NORTH LINCOLNSHIRE GREEN ENERGY PARK LTD
 Consultant: BURO HAPPOLD
 Project: NORTH LINCOLNSHIRE GREEN ENERGY PARK
 Dwg Title: INDICATIVE HIGHWAYS PLAN SHEET 5

Planning Inspectorate No. EN010116	Scale@A1 1:2500	
Drawn/Designed By: J.SLEEMAN	Checked By: C.BYRNE	Approved By: C.BYRNE
Drawing No. NLGEP-BHE-XX-XX-DR-C-2275	Revision P1	

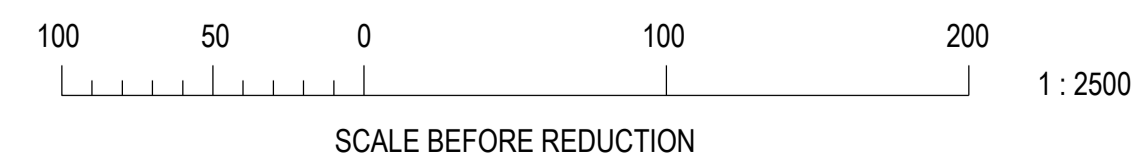

REFER TO DWG NO. NLGEP-BHE-XX-XX-DR-C-2274 FOR CONTINUATION

Maple Green 13060000 North Lincoln Green Energy Park/PSD Dwg - Infrastructure/Sheet/DCO/EN010116/EN010116-XX-XX-DR-C-2275/EN010116-XX-XX-DR-C-2275-PSD.dwg